

Scale
100 perches
to an Inch

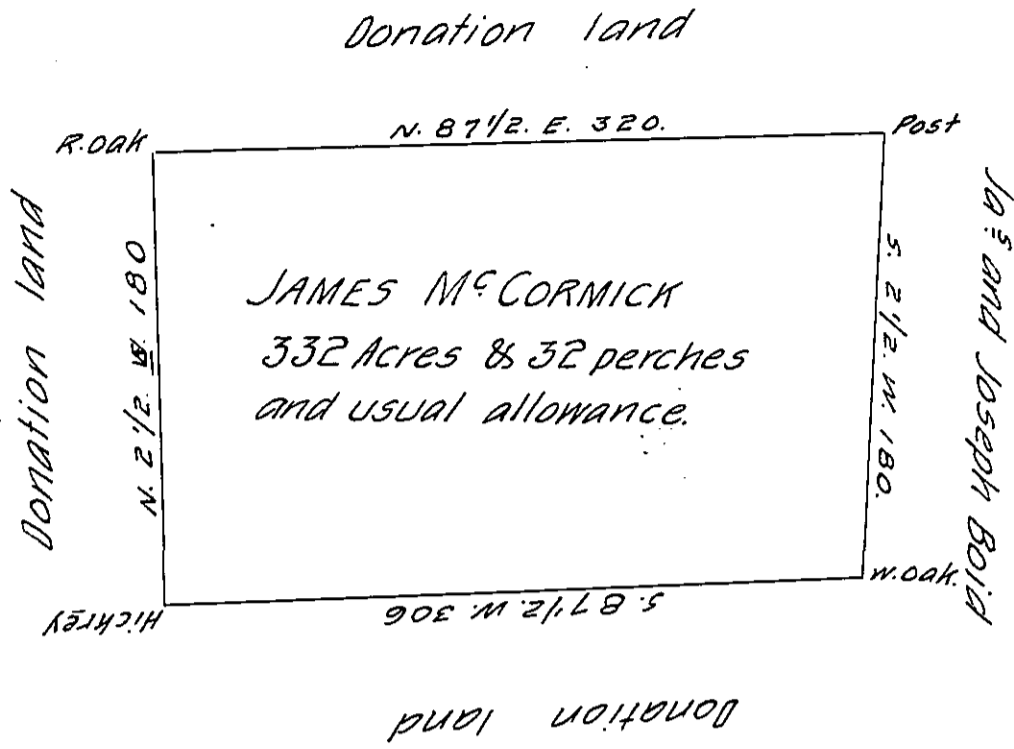

Surveyed for Jas^s McCormick.

Situate in Sandy Creek Township, Mercer County, Containing 332 Acres, 32 perches with-usual allowance. Surveyed the 21st of September 1837, in pursuant of an actual Settlement Commenced in 1820 or-21, and continued to this Date, said land is Lot N^o 85 in 5th De^t Donation land, said to be undrawn October 9th 1837.

B. Alexander, D. S.

John Taylor, Esq. S. G.

IN TESTIMONY that the above is a copy of the original remaining on file in the Department of Internal Affairs of Pennsylvania, made conformably to an Act of Assembly approved the 16th day of February, 1833, I have hereunto set my Hand and caused the Seal of said Department to be affixed at Harrisburg, this fifth day of March 1906.

Isaac D. Pearson
Secretary of Internal Affairs.